



享 誉 全 球 的 未 来 大 学



留学生入学指南

2022

Admission Information for International Students

International Admissions Office (IAO)

P03

P04

P05

P07

P08

P09

P11

P12

P13

P16

P17

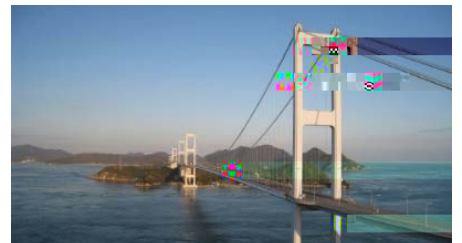
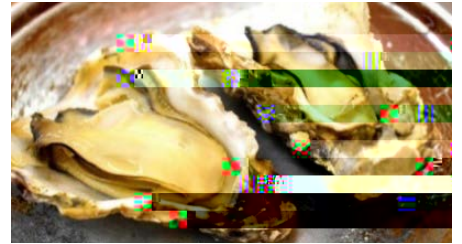
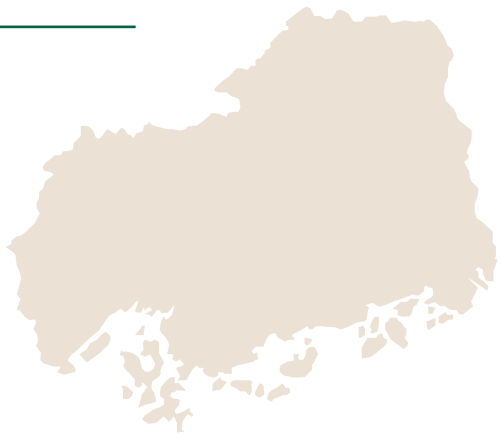

1949 24

12 4 1

11000 4500

84 1638

2022 5 1

10,603
4,463

524

3,579

55

347

51

366

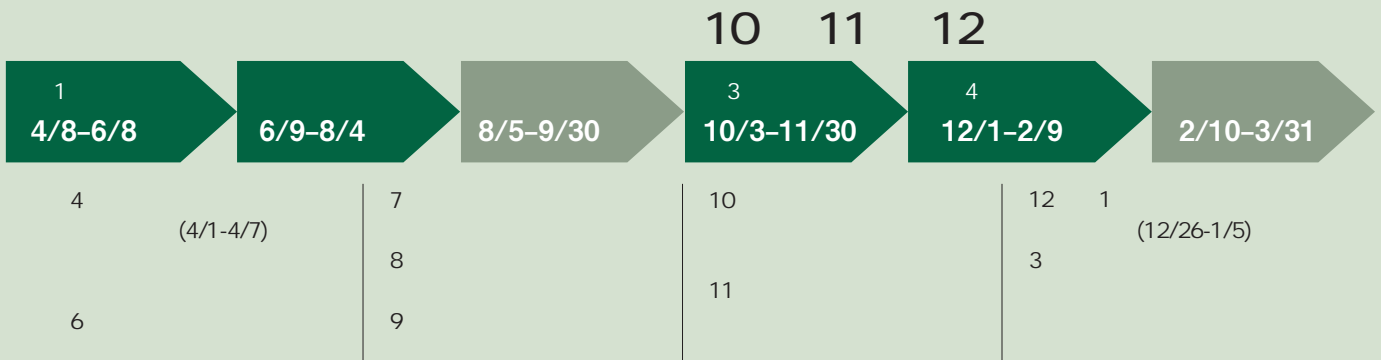



SMART SOCIETY	
2023 4	

- <http://phoenixprogramlp.hiroshima-u.ac.jp/>
- <https://taoyaka.hiroshima-u.ac.jp/>
- <https://genome.hiroshima-u.ac.jp/>

IGS

4

6

4

6

2

IGS

IGS

Zffbe://i i i .Z[daeZ[S-g.SU`b/ kgeZ[/ka] aQ/aYS/ka] a

IGS

Zffbe://i i i .Z[daeZ[S-g.SU`b/ kgeZ[/YS] gTg/YS] gTgQZW` kg

4

	1	2023 3 31	2023	
	2	12	2023 3 31	
	3		150	2023 3 31
	1:	12	2023 3 31	
	2:	International Baccalaureate	Abitur	Baccalaureate GCE A-level
1	Zffbe://i i i .V` USU`b/			
	153-8501	2-19-23	TEL	03-3465-8600
2	1	2	2	3
	Zffbe://i i i .Z[daeZ[S-g.SU`b/ kgeZ[/ka] aQ/aYS/ka] a			
	739-8511	3 2		
	E-mail: ` kge[-Ydagb@ a UWZ[daeZ[S-g.SU`b			

" 2022

EJU " "

"

UCARO

300



2 22 2

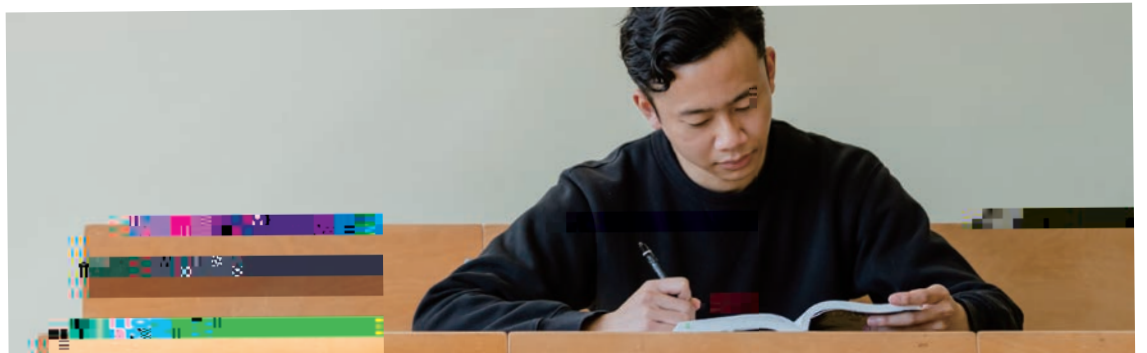



	1	14		
	2	12		
	3			
	1	16		
	2			
			30	4
		9800		
	1			
	2			
	3			
	4			
	5			
	6			
			4	10
		1	1	
	(1)			
	(2)	3		



International Admissions Assistant System (IAAS)

International Admissions Assistant System (IAAS)

IAAS IAO ([Sa-Ua` fSUf@ Z[daeZ[_ S-g.SU`b])

IAO

IAAS

IAO

"

"

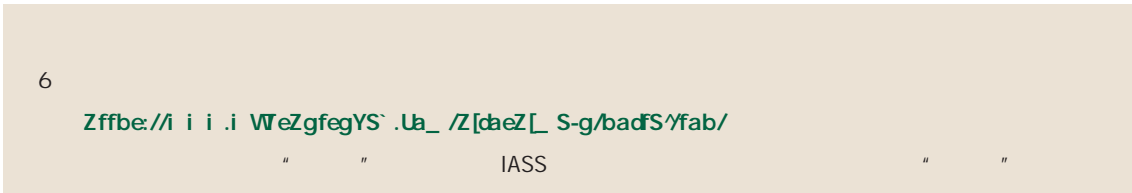
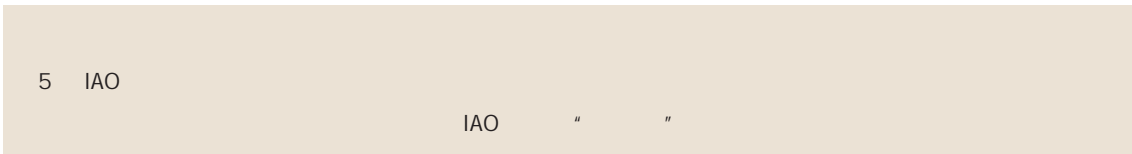
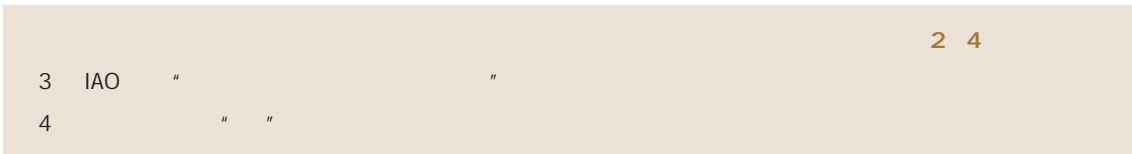
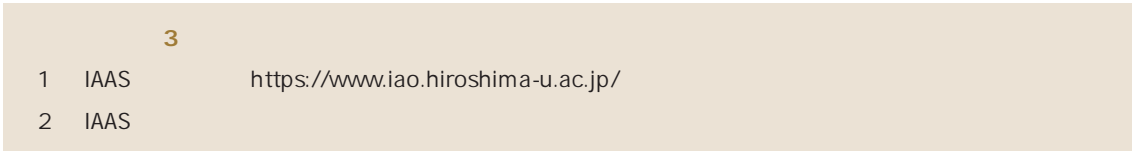

Statement of Purpose

TOEFL TOEIC IELTS

JLPT

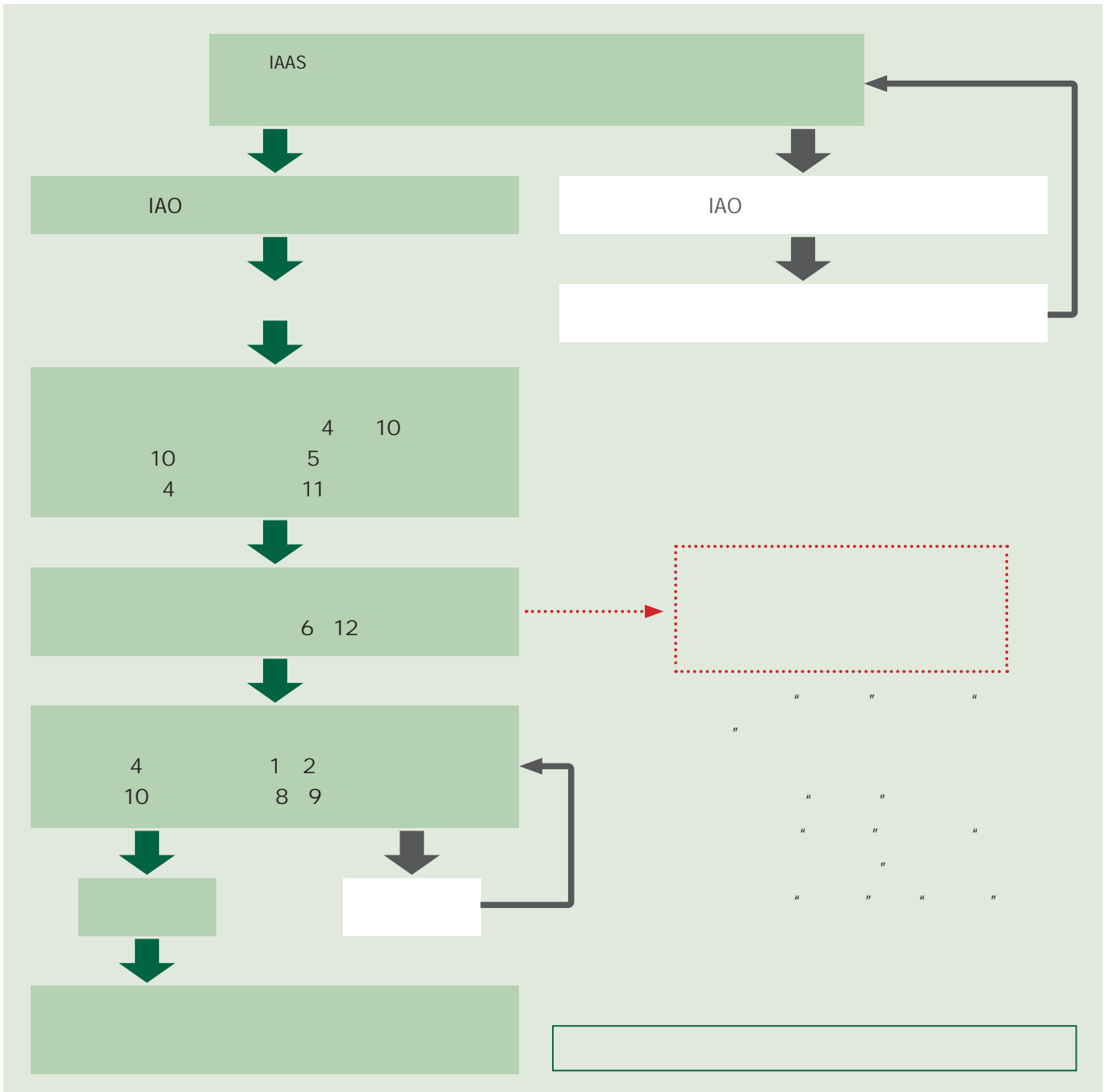

	17000	282000	535800
	30000	282000	535800
	30000	282000	535800
	9800	84600	29700

6 3

https://momiji.hiroshima-u.ac.jp/momiji-top/life/keizaishien/f_nancial.html

各居住地区每月平均支出额 (摘选)

	174000	156000	142000	158000

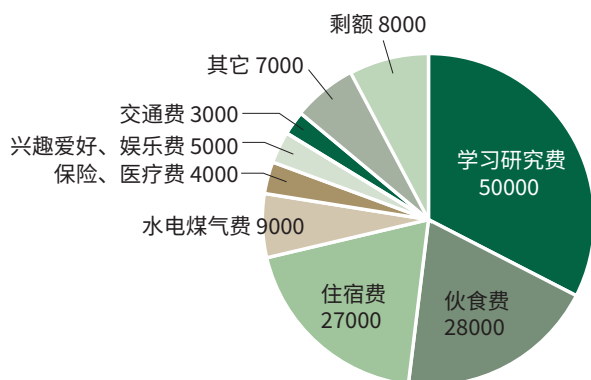

9 2



			*
		10-3	50000 1 4



	1 1	
		15 16

40

230

民間団体奨学金獲得者比例

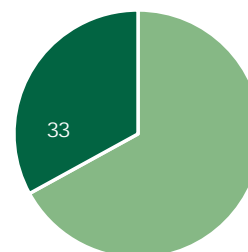

<https://momiji.hiroshima-u.ac.jp/momiji-top/international/privatescholarship.html>

(JASSO)

http://www.jasso.go.jp/ryugaku/study_j/scholarships/index.html

	" "
	1
	20000 200000
	7 6



外国留学生住宿情况
(截至2022年5月)

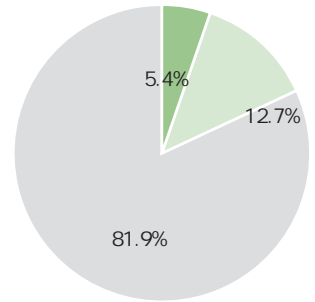

2 7

1

2-457

https://www.hiroshima-u.ac.jp/cn/centers/welfare_facilities/international_house

	A		B		B	
	1K	13.3	1DK	44.5	2DK	57.5
	60		5		5	
	5900	/	9500	/	14200	/
	2500	/	2800	/	3100	/



2-812-62

<https://www.hiroshima-u.ac.jp/hyugaku/shien/jyuukyo/gakuseisyukusya>

	A		B		C		D	
	10		12		14		12	
	292	64	100	50	100	51	200	55
	7500	/	4700	/	15000	/	4700	/
	10000	/	10000	/	10000	/	10000	/
	1900	/	2000	/	1200	/	2000	/



2021 10

1

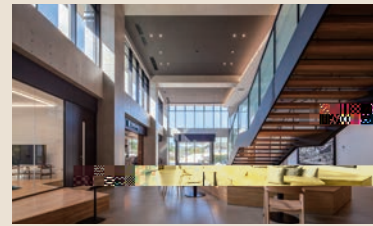

		1K	16.7
			34
		40000	/
		10000	/
	4000	/	
		LAN	

<https://www.hucoop.com/apart/index.html>

17000 31000

COLLEGE COURT

<http://www.hitorigurashi.com/estate/2301006105/>

COLLEGE COURT

<http://www.hitorigurashi.com/estate/2301006104/>

DORMITORY

<https://dormy-ac.com/placehall/chugoku/higashihiroshima/13383/>



Sg` ecgSdW

28-6

<http://www.jkk-hiroshima.or.jp/chintai/sunsquare/>

" Sunsquare "

		A J	B
	1K 17.46	A: 1K 35.31 J: 1K 34.83	1K 52.83
	90	A: 20 , J: 5	2
	20000 /	35000 /	42800 /
	2500 /	3500 /	3500 /
	1000 /	1000 /	1000 /
	40000	70000	85600 /

PLAZA

3-3-1

Global Relations Program GRP

<https://hiroshima-hip.or.jp/cn/>

PLAZA

		1-2	
		24950	27350 /

1-1

<http://www.i-house-hiroshima.jp/>

*

	2	2
	26000 /	36000 /

20000 50000

30000

80000

2018 9 3+1



" " " " " " " "

1 3

https://www.hiroshima-u.ac.jp/international/admissions/admission_guide/residentstatus/procedure



<https://www.hiroshima-u.ac.jp/gcdc/en/ForInternationalStudents>



	739-8521		TEL +81-82-424-6315 FAX +81-82-424-8246 souka-gaku-sien@of ce.hiroshima-u.ac.jp
	739-8522		TEL +81-82-424-6613 FAX +81-82-424-0315 bun-gaku-sien@of ce.hiroshima-u.ac.jp
	739-8524		TEL +81-82-424-6725 FAX +81-82-424-7108 kyoiku-gakusi@of ce.hiroshima-u.ac.jp
	739-8525		TEL +81-82-424-7215 FAX +81-82-424-7220 syakai-gaku-sien@of ce.hiroshima-u.ac.jp
2023 4	730-0053	1 89	TEL +81-82-542-6998 FAX +81-82-542-6964 senda-gaku-sien@of ce.hiroshima-u.ac.jp
	739-8525		TEL +81-82-424-7217 FAX +81-82-424-7220 syakai-gaku-sien@of ce.hiroshima-u.ac.jp
	739-8526		TEL +81-82-424-7309 FAX +81-82-424-2464 ri-gaku-sien@of ce.hiroshima-u.ac.jp
	734-8553		TEL +81-82-257-1705 FAX +81-82-257-5278 kasumi-kokusai@of ce.hiroshima-u.ac.jp
	734-8553		TEL +81-82-257-1705 FAX +81-82-257-5278 kasumi-kokusai@of ce.hiroshima-u.ac.jp
	734-8553		TEL +81-82-257-1705 FAX +81-82-257-5278 kasumi-kokusai@of ce.hiroshima-u.ac.jp
	739-8527		TEL +81-82-424-7515 FAX +81-82-424-5461 kou-gaku-gakubu@of ce.hiroshima-u.ac.jp
	739-8528		TEL +81-82-424-7915 FAX +81-82-424-6480 sei-gaku-sien@of ce.hiroshima-u.ac.jp
	739-8527		TEL +81-82-424-7611 FAX +81-82-424-5461 kou-gaku-gakubu@of ce.hiroshima-u.ac.jp

739-8522			TEL +81-82-424-6615 FAX +81-82-424-0315 bun-gaku-sien@of ce.hiroshima-u.ac.jp
739-8525			TEL +81-82-424-7148 FAX +81-82-424-7220 syakai-gaku-sien@of ce.hiroshima-u.ac.jp
2023 4 730-0053		1 89	TEL +81-82-542-6998 FAX +81-82-542-6964 senda-gaku-sien@of ce.hiroshima-u.ac.jp
739-8525			TEL +81-82-424-7148 FAX +81-82-424-7220 syakai-gaku-sien@of ce.hiroshima-u.ac.jp
739-8521			TEL +81-82-424-6318 FAX +81-82-424-8246 souka-gaku-sien@of ce.hiroshima-u.ac.jp
/	/	/	
739-8524			TEL +81-82-424-3706 FAX +81-82-424-7108 kyoiku-in@of ce.hiroshima-u.ac.jp
/	/		
739-8529			TEL +81-82-424-5902 FAX +81-82-424-6904 koku-gaku@of ce.hiroshima-u.ac.jp
730-0053		89	TEL +81-82-542-6962 FAX +81-82-542-6964 senda-gaku-sien@of ce.hiroshima-u.ac.jp
730-0053		89	TEL +81-82-542-7087 FAX +81-82-542-6964 houmu-gaku-sien@of ce.hiroshima-u.ac.jp
/	/	/	
739-8526			TEL +81-82-424-7309 FAX +81-82-424-2464 ri-gaku-sien@of ce.hiroshima-u.ac.jp
/	/	/	/
739-8527			TEL +81-82-424-7518 FAX +81-82-424-5461 kou-gaku-daigakuin@of ce.hiroshima-u.ac.jp
739-8530			TEL +81-82-424-7008 FAX +81-82-424-7000 sentan-gaku-sien@of ce.hiroshima-u.ac.jp
739-8521			TEL +81-82-424-6318 FAX +81-82-424-8246 souka-gaku-sien@of ce.hiroshima-u.ac.jp
739-8529			TEL +81-82-424-5902 FAX +81-82-424-6904 koku-gaku@of ce.hiroshima-u.ac.jp
739-8530			TEL +81-82-424-7008 FAX +81-82-424-7000 sentan-gaku-sien@of ce.hiroshima-u.ac.jp
/			
739-8528			TEL +81-82-424-7908 FAX +81-82-424-6480 sei-daigakuin-sien@of ce.hiroshima-u.ac.jp
739-8521			TEL +81-82-424-6318 FAX +81-82-424-8246 souka-gaku-sien@of ce.hiroshima-u.ac.jp
/	/		
739-8526			TEL +81-82-424-7309 FAX +81-82-424-2464 ri-gaku-sien@of ce.hiroshima-u.ac.jp
734-8553			TEL +81-82-257-1705 FAX +81-82-257-5278 kasumi-kokusai@of ce.hiroshima-u.ac.jp
SMART SOCIETY 739-8528		5 1	TEL +81-82-424-5902 FAX +81-82-424-6904 smart-society@of ce.hiroshima-u.ac.jp